



Eastleigh House  
Upper Market Street  
Eastleigh SO50 9YN

21 September 2021

**HEDGE END, WEST END AND BOTLEY LOCAL AREA COMMITTEE**

**Monday, 27 September 2021**

**SUPPLEMENTARY PAPERS ENCLOSED**

Item 9 (a) Street Naming Report (Pages 3 - 6)

**TO:** Councillors Garton, Asman, Allingham, Corben, Gomer, House, Jurd, Kyrle, Pretty, Tennent, Bearder and Kinloch

Staff Contacts: Nikki Dunne, Democratic Services Officer, 02380 688298  
Email: [nikki.dunne@eastleigh.gov.uk](mailto:nikki.dunne@eastleigh.gov.uk). Please email  
[Democratic.Services@eastleigh.gov.uk](mailto:Democratic.Services@eastleigh.gov.uk) to register to  
speak before the meeting.  
Kitty Budden, Local Area Manager Tel: 023 8068 8266;  
Email: [kitty.budden@eastleigh.gov.uk](mailto:kitty.budden@eastleigh.gov.uk)

Item 1. FIELD\_TITLE

Item 2. FIELD\_TITLE

This page is intentionally left blank

## HEDGE END, WEST END AND BOTLEY LOCAL AREA COMMITTEE

Monday, 27 September 2021

### STREET NAMING REPORT

#### Report of the Trainee Highways Engineer

---

#### Recommendation(s)

It is recommended that the name 'Deer Park Avenue' for a new road near Woodside Lane is accepted by Councillors.

---

#### Summary

The report recommends an appropriate street name for a road located in a new development off Woodhouse Lane as per planning application number O/18/83634, following consideration of the options presented by the developer.

#### Statutory Powers

Town Improvement Clauses Act 1847, section 65  
Public Health Act, 1925, section 19  
Local Government Act 1972, Section 111.

#### Strategic Implications

1. The provision of this development forms part of Eastleigh Borough Council's objective to create an Excellent Environment for All, including a distinct sense of 'place' and identity. This is achieved by enabling the construction of a clean and attractive environment for residents to live in and appropriate signage and naming in new developments.

#### Introduction

2. The name Deer Park Avenue has been proposed by the developer for the main spine road of the estate which will (when completed) lead to Deer Park School. See Appendix 1.

#### Considerations

3. Construction work is under way on this development and the Developer is required to have an agreed name for the roads within the development, to enable the public utility apparatus to be installed and eventually, for residential addresses to be allocated to properties.

### **Financial Implications**

4. There are no direct financial implications of this report but a delay in naming this road could delay the completion of the development and occupations.

### **Risk Assessment**

6. Whilst a formal risk assessment has not been conducted, it is recognised that the consequence of not naming this road at this time poses a risk to the timely completion of the adjacent properties and occupation. If a property does not have an official postal address, it will not be registered on any database, for example Hampshire Fire and Rescue service, Hampshire constabulary and the Ambulance Service who must maintain up to date record in the case of an emergency call out.

### **Equality and Diversity Implications**

7. The Equality Act is not relevant to the decision in this report because

- It is a response to a consultation by an external organisation.

Therefore, it is considered that for this decision the Equality Duty does not need to be addressed and an Equality Impact Assessment (EqIA) has not been carried out.

8. **Climate Change and Environmental Implications**

The proposal to name this road does not have any Climate change or environmental implications.

### **Conclusion**

9. Deer Park Avenue to be registered as the name for the new road.

DEBBIE DEBRECENI  
TRAINEE HIGHWAYS ENGINEER

Date: 19 August 2021  
Contact Officer: Debbie Debrececi  
Tel No:  
e-mail: [debbie.debrececi@eastleigh.gov.uk](mailto:debbie.debrececi@eastleigh.gov.uk)

Appendices Attached: Appendix 1 Location Plan

### LOCAL GOVERNMENT ACT 1972 - SECTION 100D

The following is a list of documents which disclose facts or matters on which this report or an important part of it is based and have been relied upon to a material extent in the preparation of this report. This list does not include any published works or documents which would disclose exempt or confidential information.

background papers: None.

Appendix 1 Location Plan

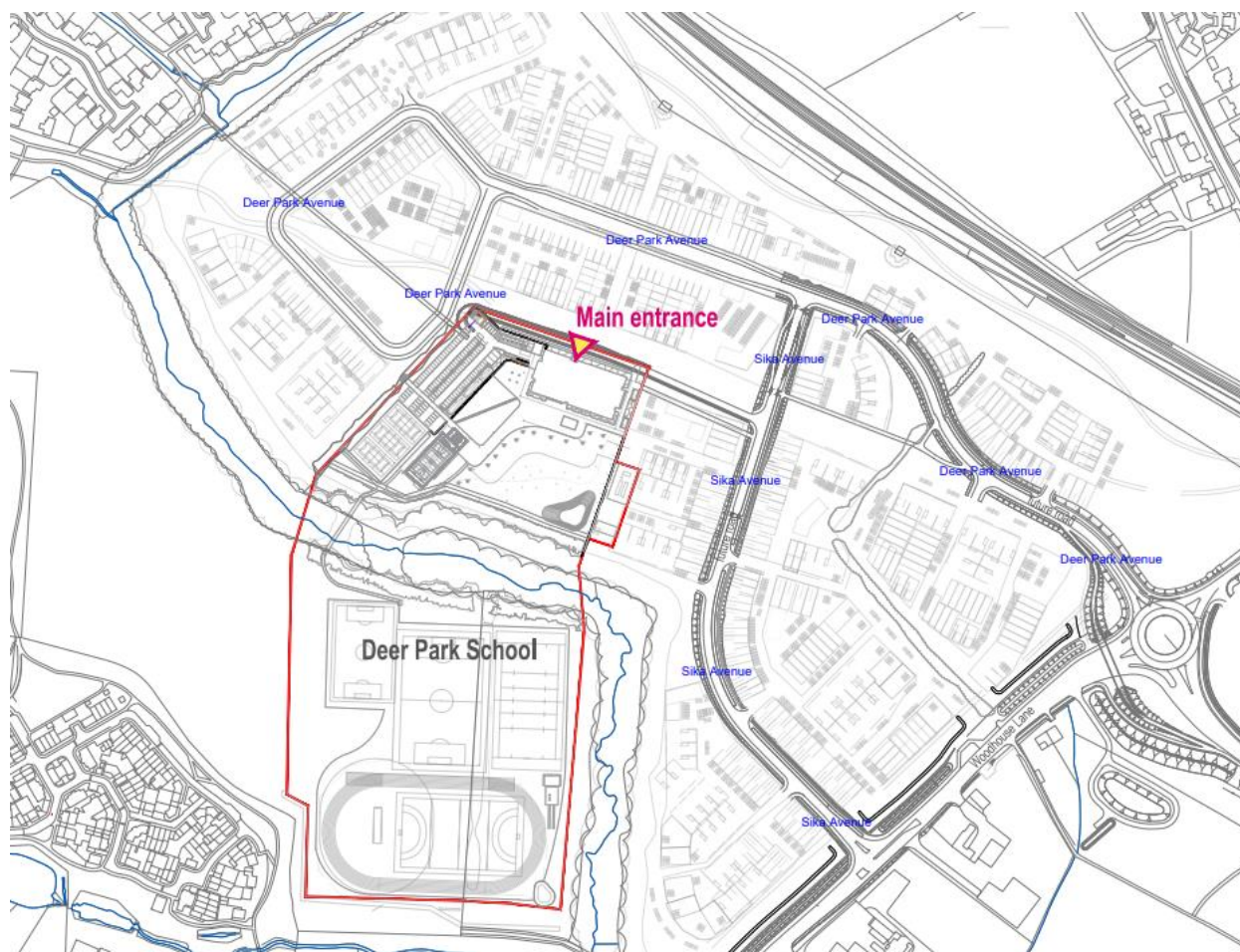

This page is intentionally left blank